

Visby

Total area - 21,63 m²

External dimensions - 3,5x8,7 m

Height - 3,04 m

Weight - 8 t



Floor plan

Total area - 21,63 m²

KITCHEN + room - 12,06 m²

Bathroom - 2,55 m²

Bedroom - 7,02 m²

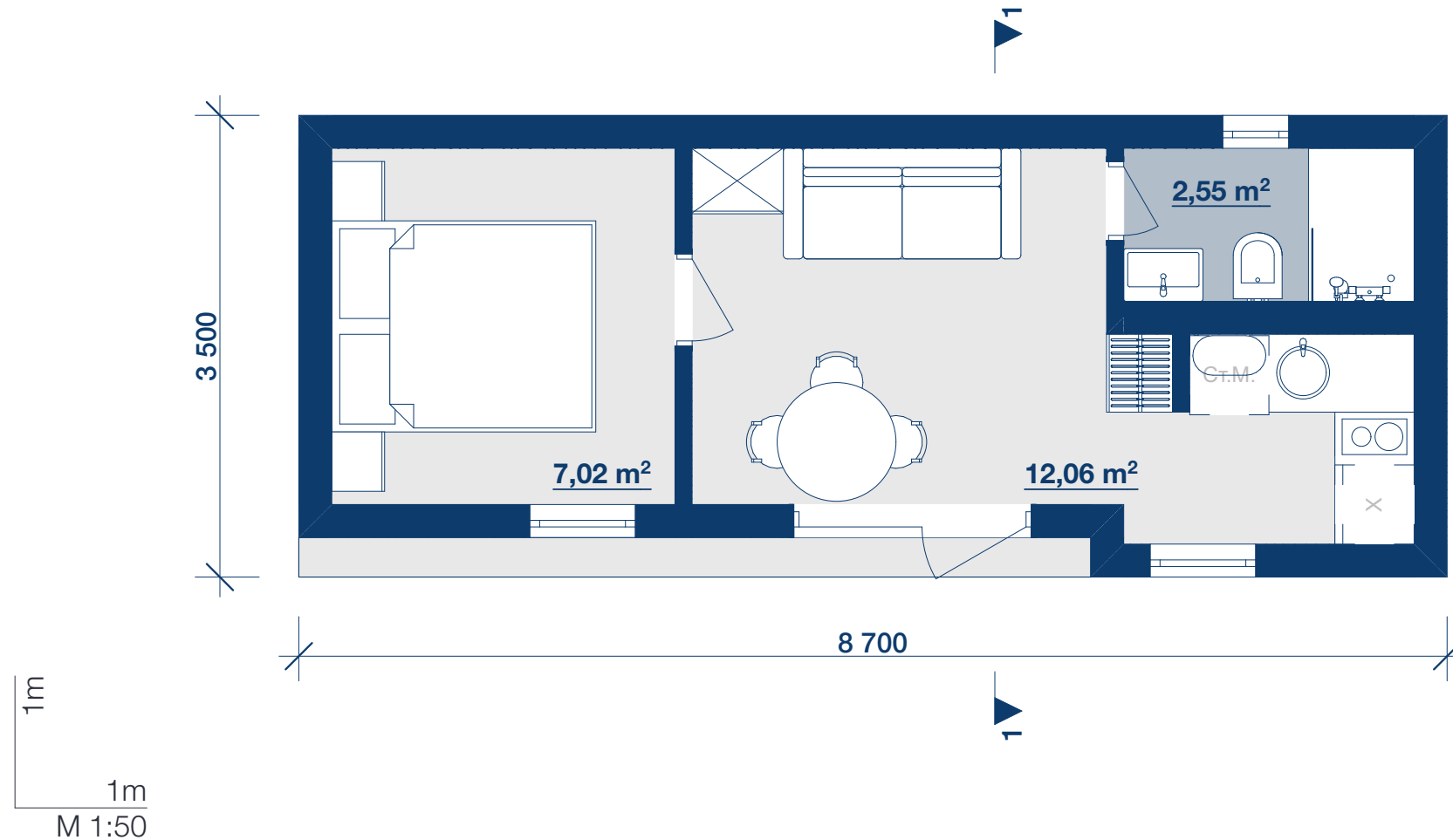

Section 1

Roof pitch - 2°
Height - 3,04 m

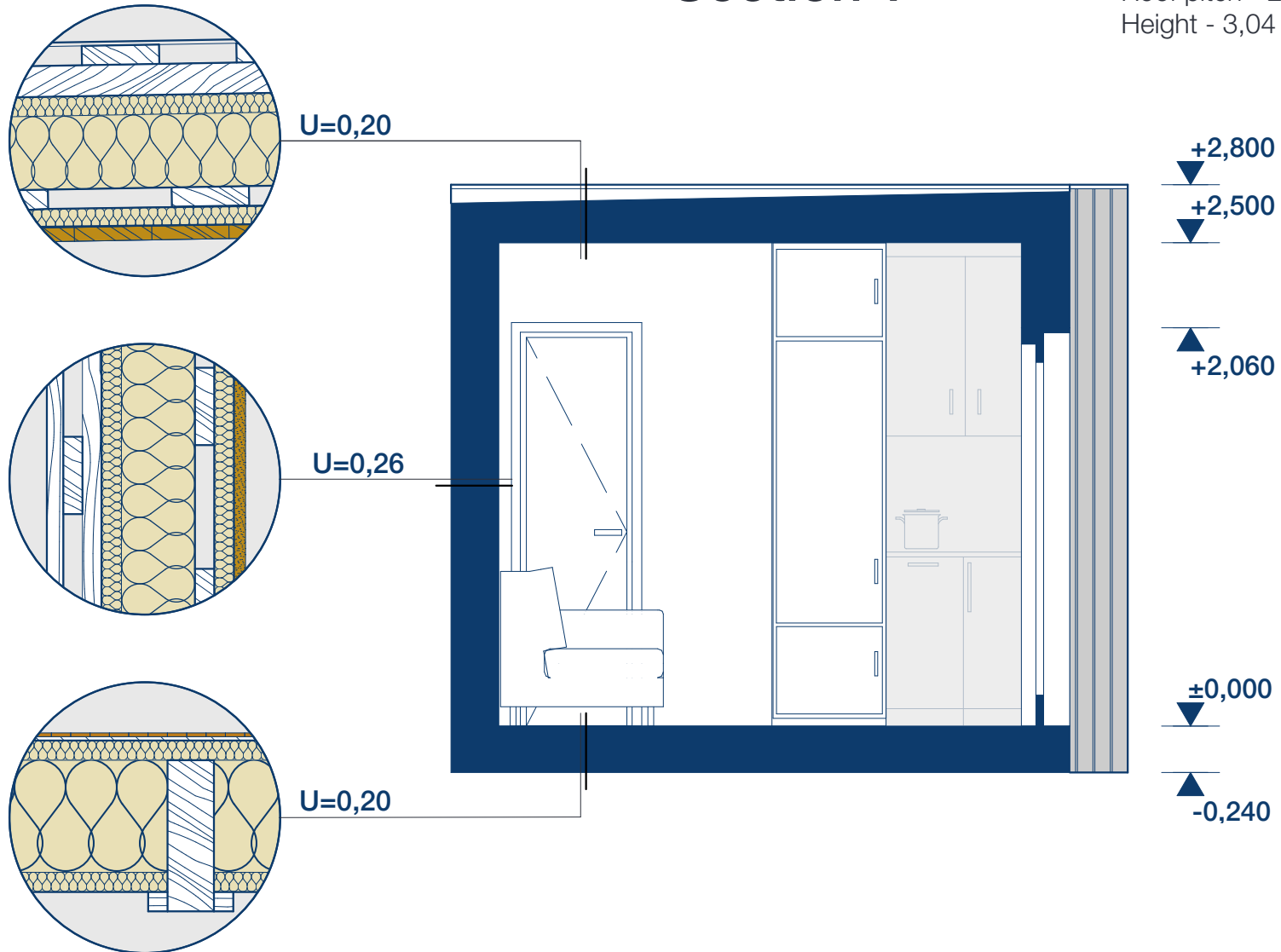

Ecological and durable materials

We produce houses from ecological materials **using wood and wood-based materials**. We do not use films, which means our homes do not require additional conditioning and recovery.



House frame

The entire roof and wall frame of the house is **made of wood C24** (pine).

The size of the beams used is based on strength calculations and to ensure stability of the structure.

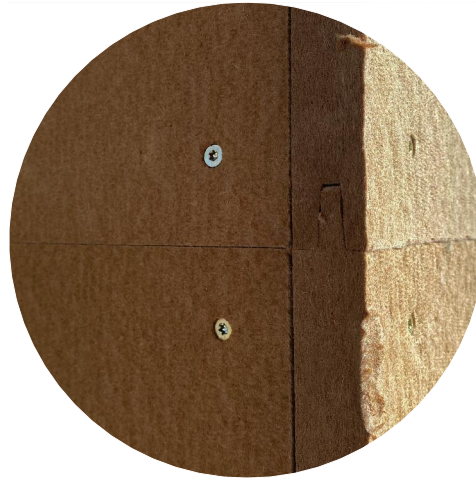

House insulation

Wood fibre board $\lambda=0,045$
It is made from 100% wood fibers mixed pressed into dense panels.

Cellulose insulation $\lambda=0,036$
It is made from recycled paper waste.



Exterior finish

Wall finishing - a board painted or treated with eco-friendly compounds for wood (color to choose).

Roofing material - classic metal roofing covering.



Interior fitting

100% clay without harmful chemical compounds. 16 natural shades to choose from.

or a painted board painted or treated with eco-friendly compounds for wood.