

Project of a modular house

Frederika

Total area - 37,23 m²

External dimensions - 3,5x8,5 m

Height - 3,97 m

Weight - 8 t



Floor plan

KITCHEN + room - 13,37 m²
Bathroom - 2,95 m²
Bedroom - 6,60 m²

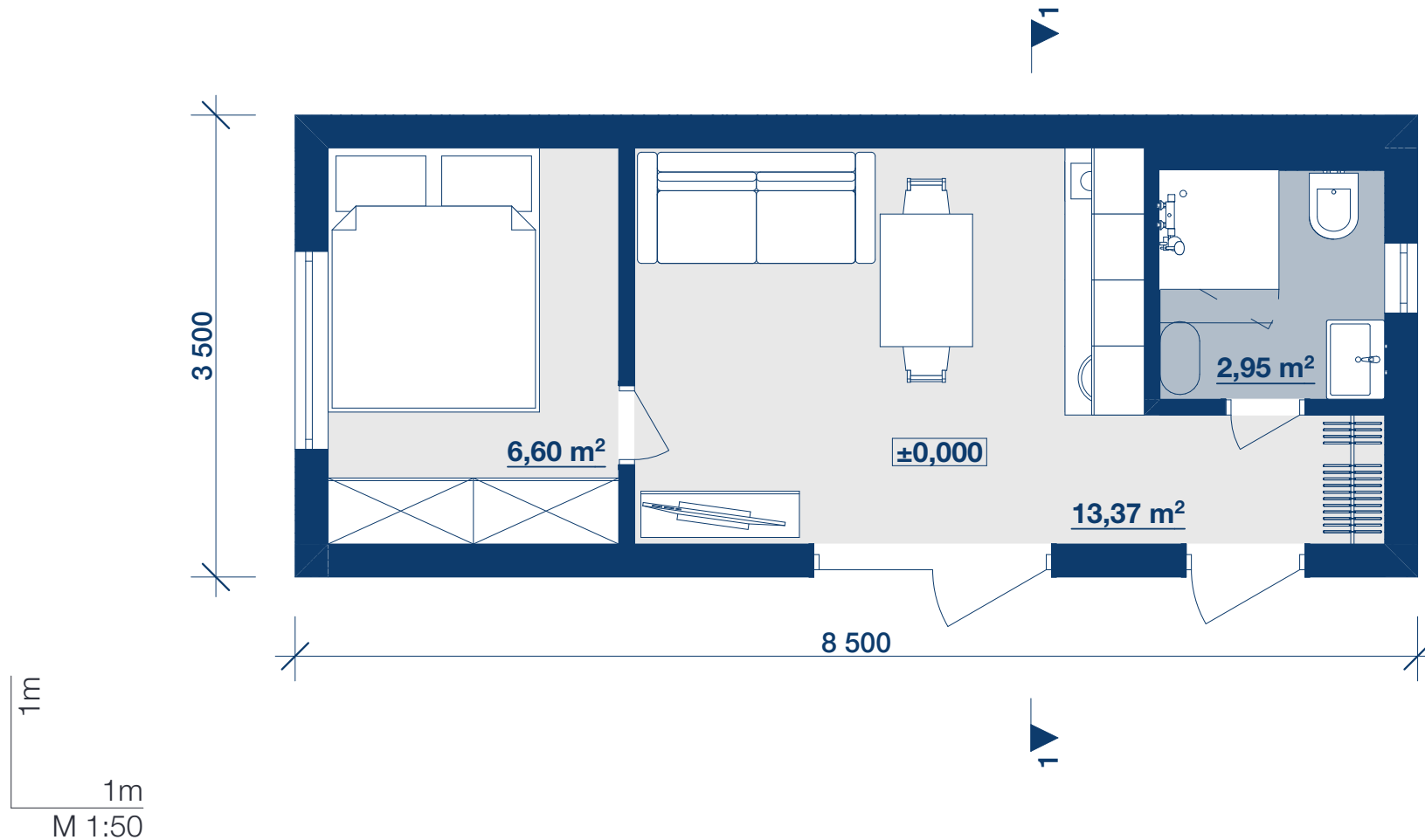

Loft plan

Loft 1 - 7,35 m²

Loft 2 - 6,96 m²

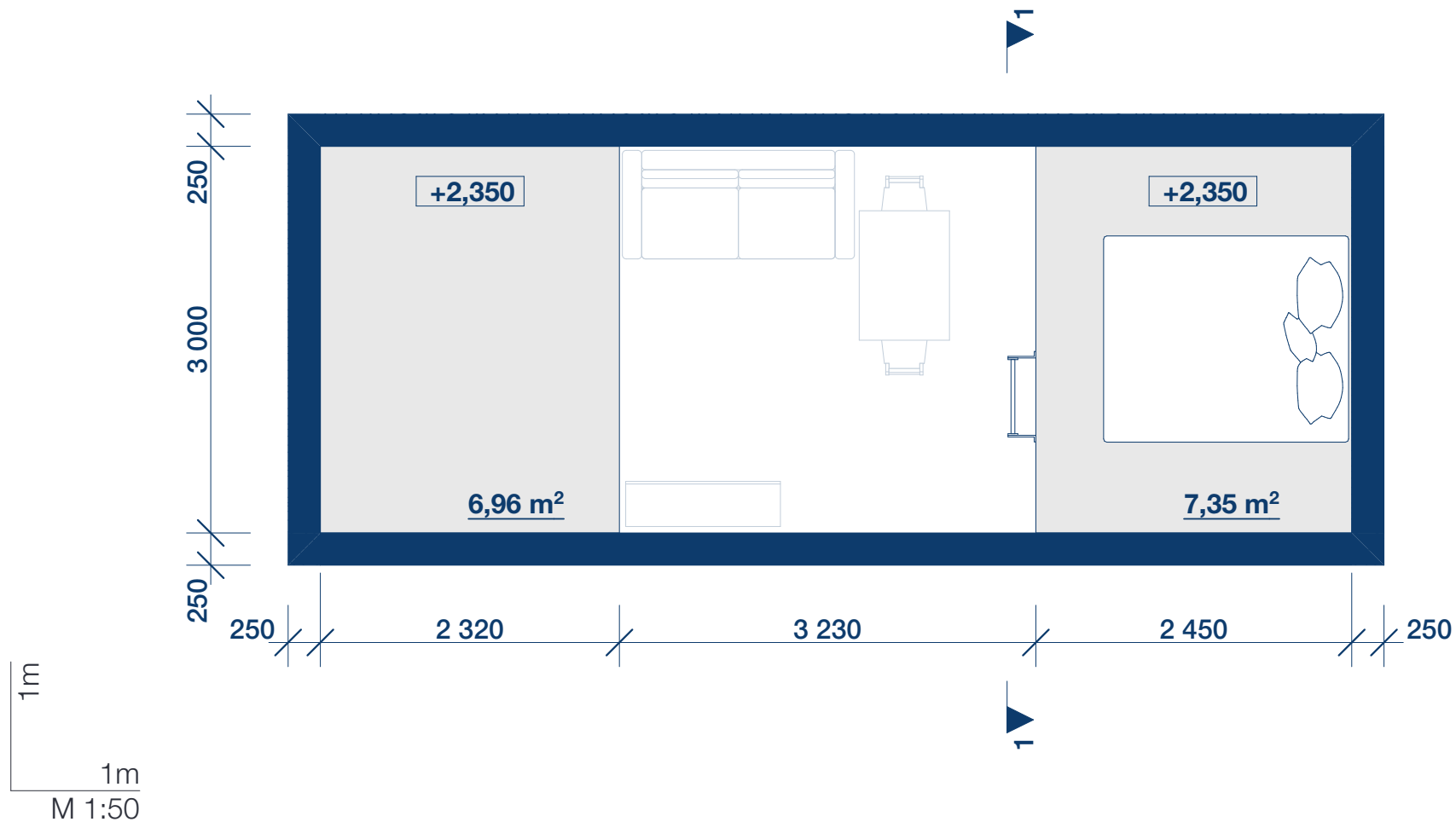

Section 1

Roof pitch - 41°
Height - 3,97 m

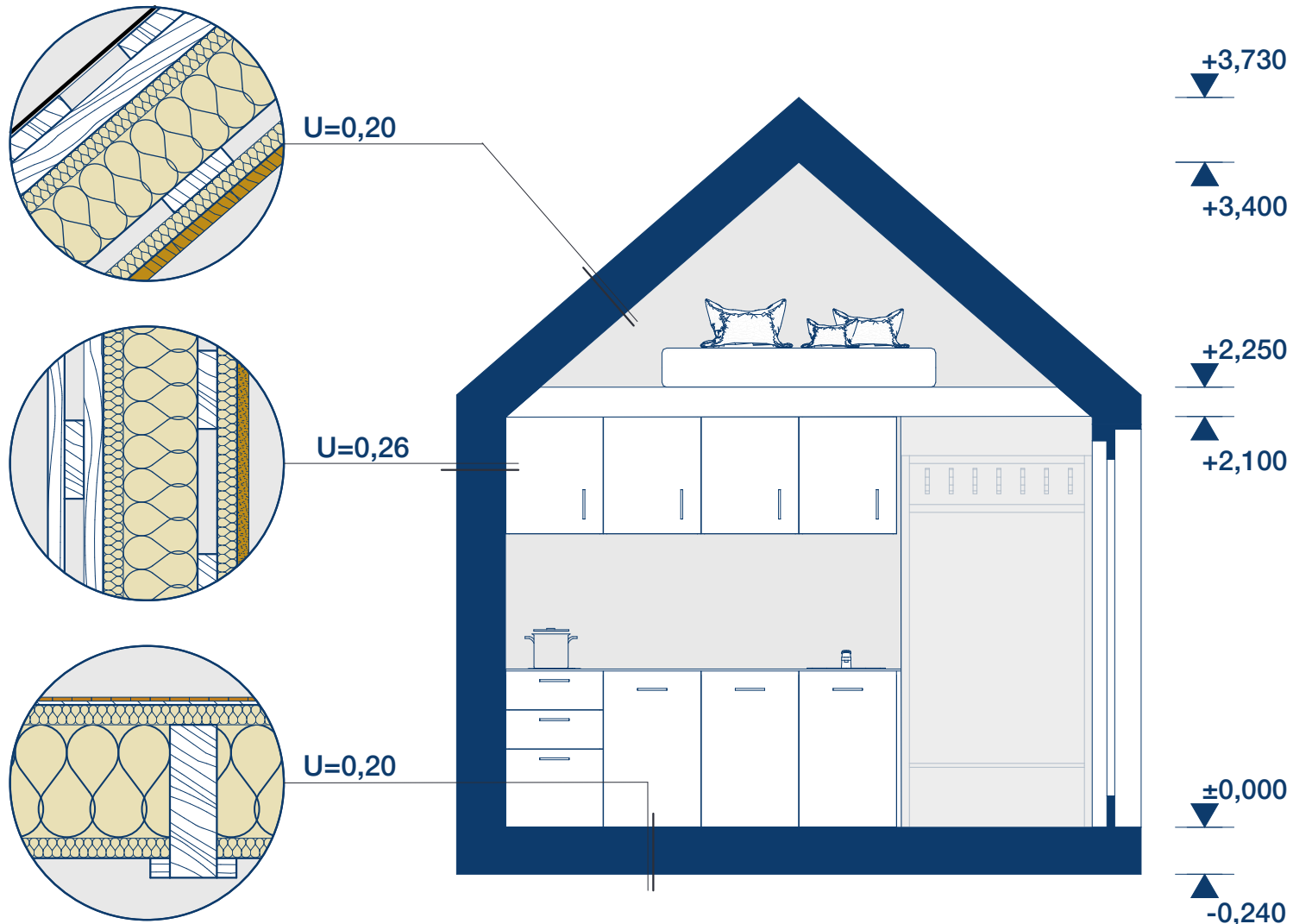

Ecological and durable materials

We produce houses from ecological materials **using wood and wood-based materials**. We do not use films, which means our homes do not require additional conditioning and recovery.



House frame

The entire roof and wall frame of the house is **made of wood C24** (pine).

The size of the beams used is based on strength calculations and to ensure stability of the structure.

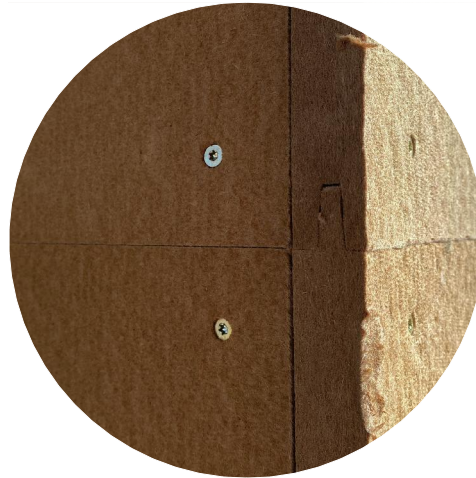

House insulation

Wood fibre board $\lambda=0,045$
It is made from 100% wood fibers mixed pressed into dense panels.

Cellulose insulation $\lambda=0,036$
It is made from recycled paper waste.



Exterior finish

Wall finishing - a board painted or treated with eco-friendly compounds for wood (color to choose).

Roofing material - classic metal roofing covering.



Interior fitting

100% clay without harmful chemical compounds. 16 natural shades to choose from.

or a painted board painted or treated with eco-friendly compounds for wood.