

Aston

Total area - 35,11 m²
External dimensions - 3,5x8,5 m
Height - 4,00 m
Weight - 11 t



Floor plan

Living room - 13,30 m²
Kitchen - 5,51 m²
Bathroom - 3,22 m²

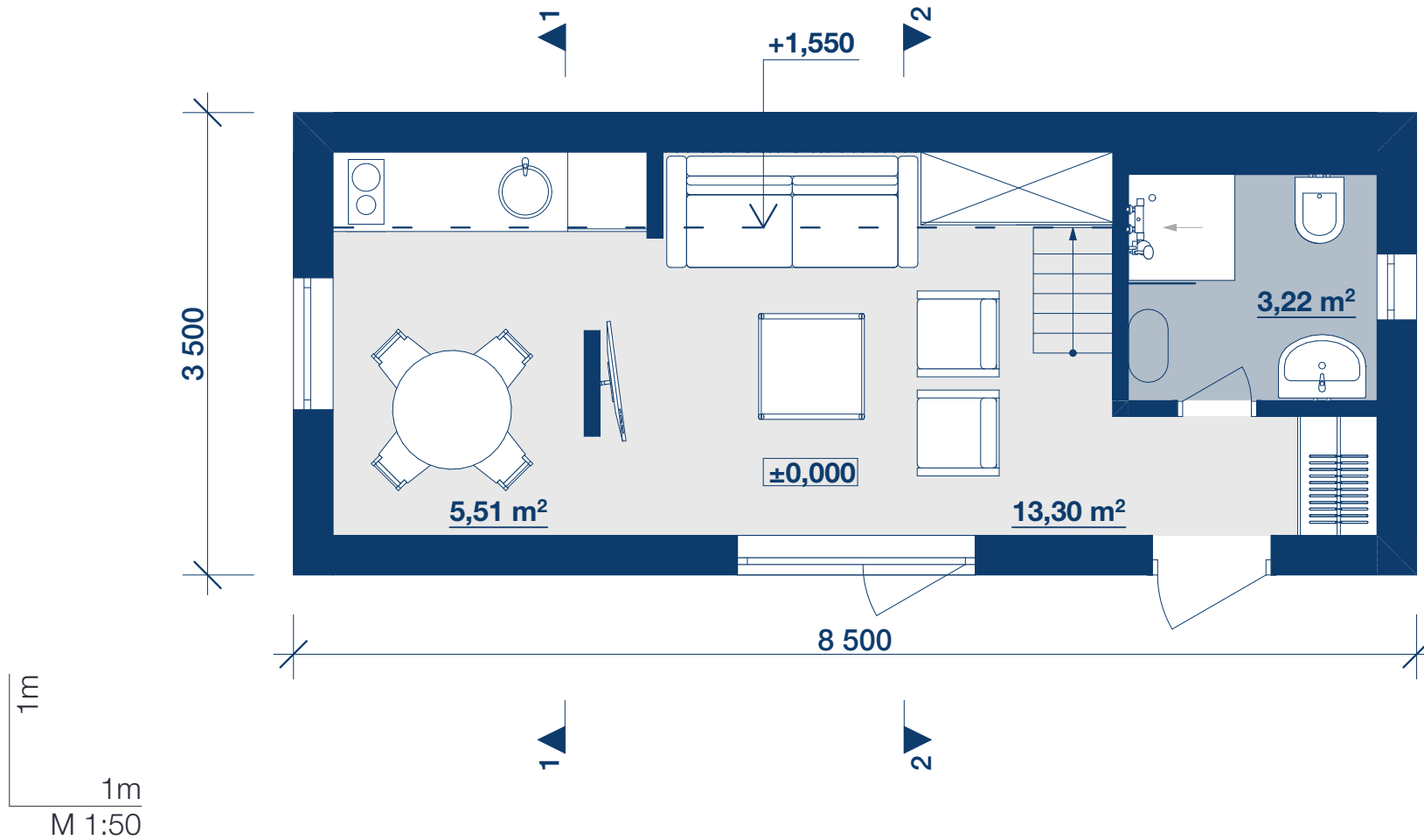

Loft plan

Mezzanine - 3,15 m²
Loft 1 - 5,37 m²
Loft 2 - 4,56 m²

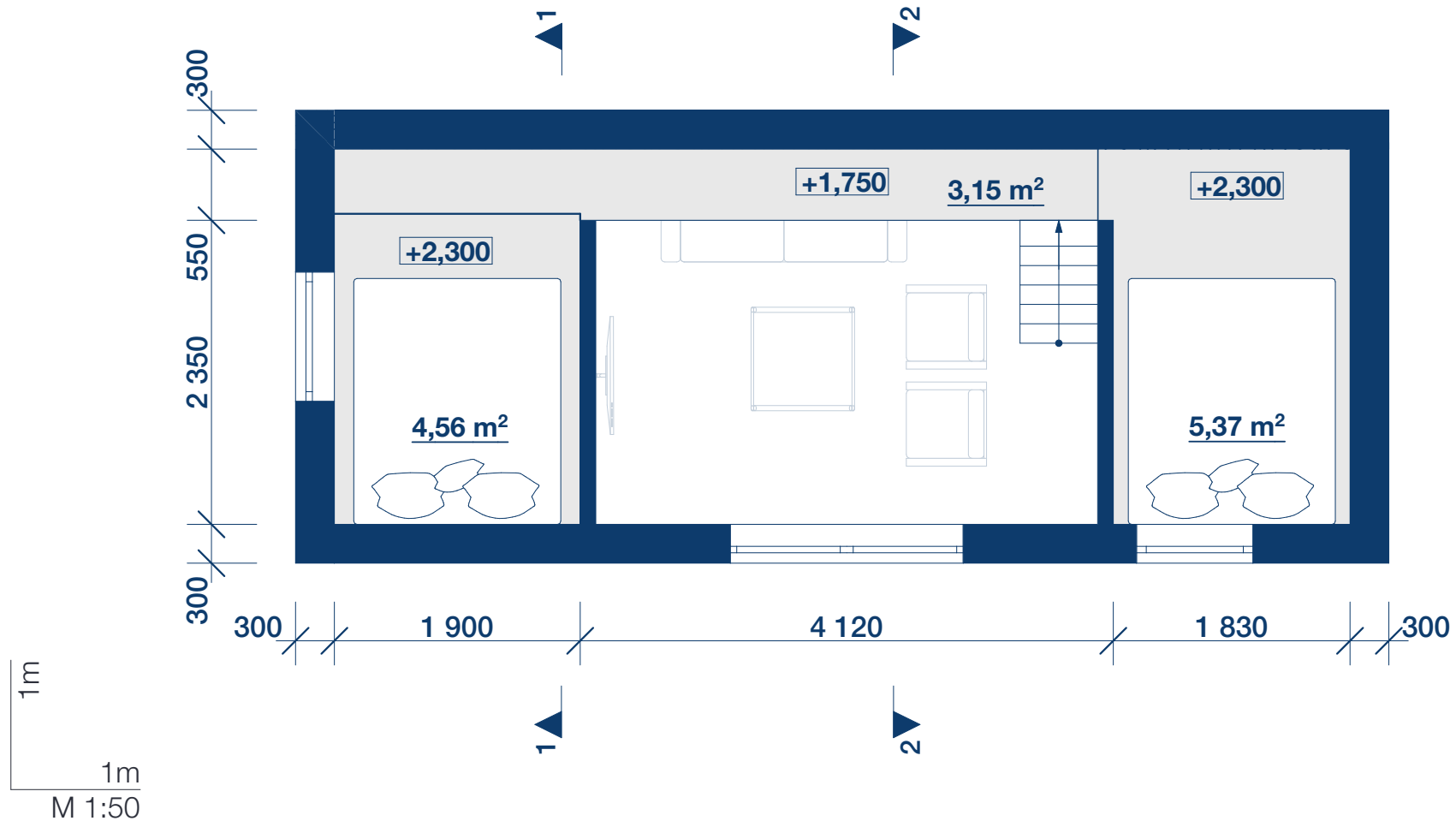

Section 1

Roof pitch - 2°
Height - 4,00 m

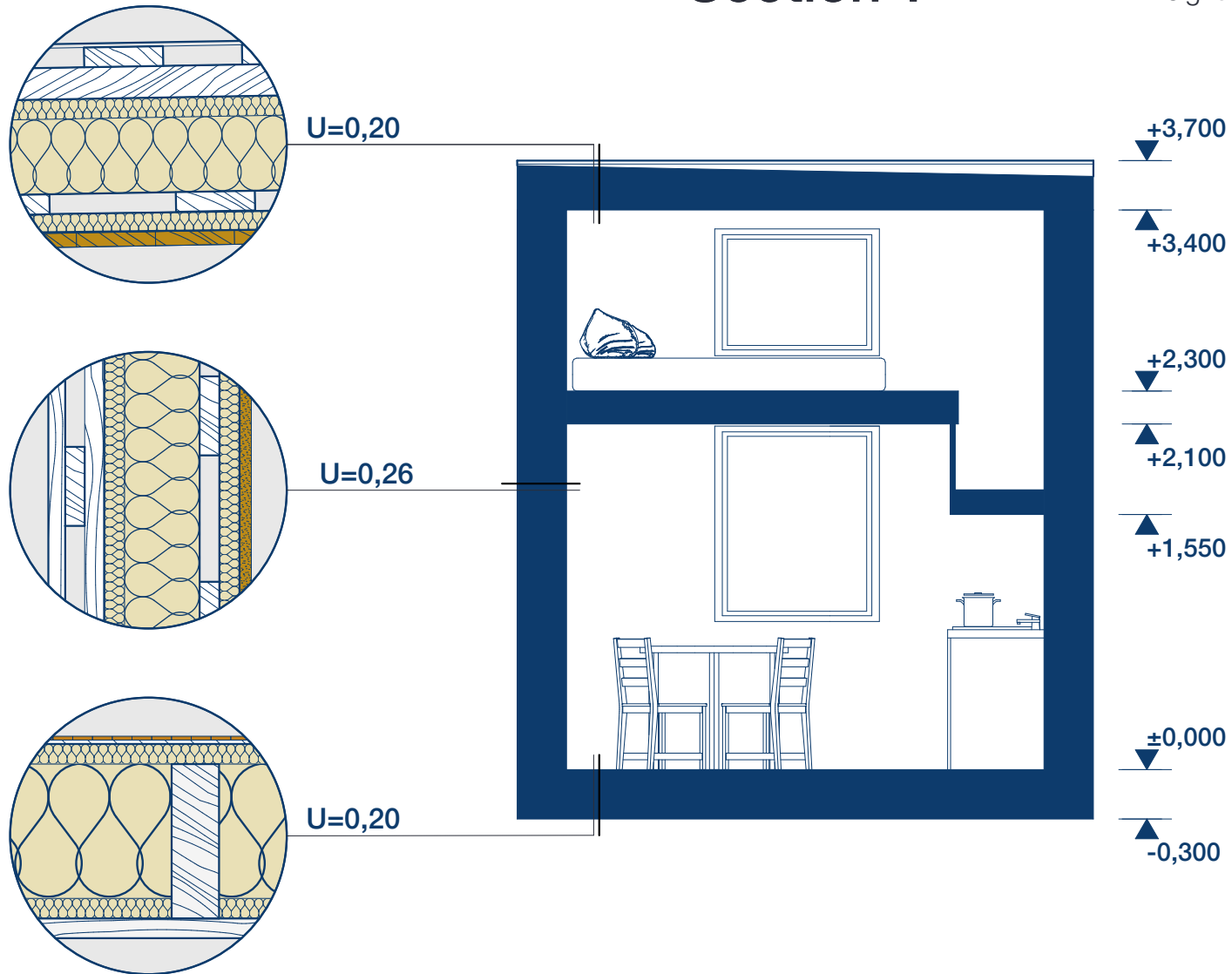

1m
M 1:40

Section 2

Roof pitch - 2°
Height - 4,00 m

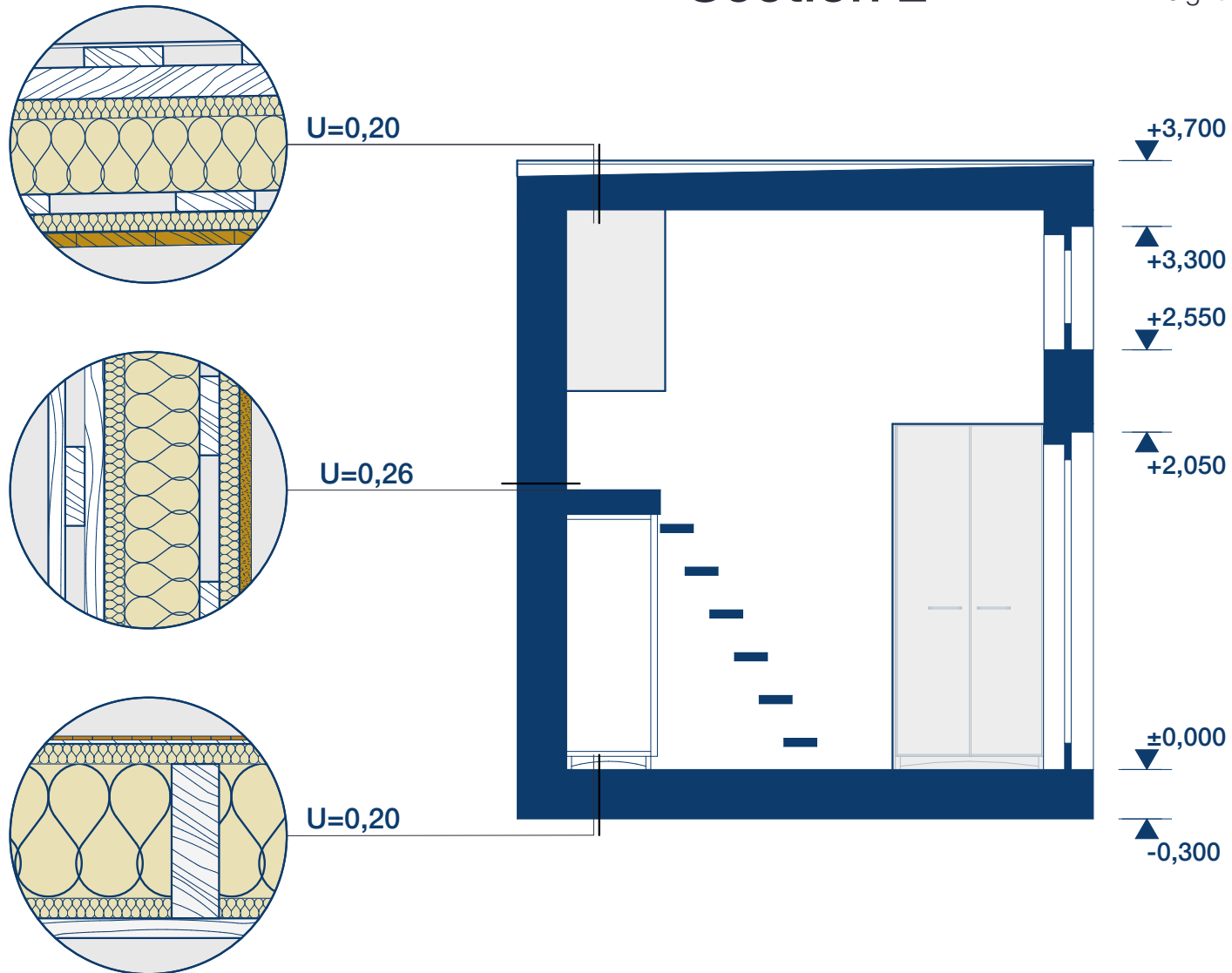

1m
M 1:40

Ecological and durable materials

We produce houses from ecological materials **using wood and wood-based materials**. We do not use films, which means our homes do not require additional conditioning and recovery.



House frame

The entire roof and wall frame of the house is **made of wood C24** (pine).

The size of the beams used is based on strength calculations and to ensure stability of the structure.

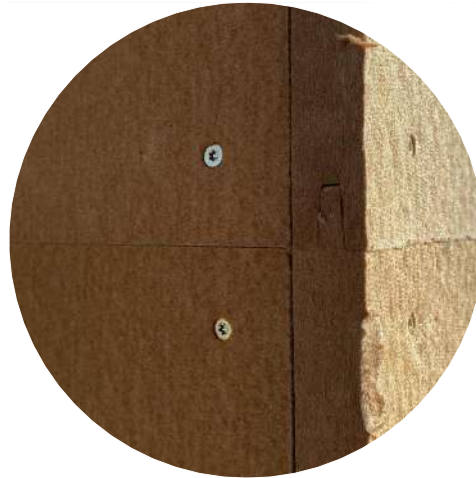

House insulation

Wood fibre board $\lambda=0,045$
It is made from 100% wood fibers mixed pressed into dense panels.

Cellulose insulation $\lambda=0,036$
It is made from recycled paper waste.



Exterior finish

Wall finishing - a board painted or treated with eco-friendly compounds for wood (color to choose).

Roofing material - classic metal roofing covering.



Interior fitting

100% clay without harmful chemical compounds. 16 natural shades to choose from.

or a painted board painted or treated with eco-friendly compounds for wood.